

Gleniffer High School Welcomes Primary Seven



MOVING TO SECONDARY SCHOOL

Introduction

For some pupils, moving to a secondary school can be an anxious time. This year is particularly difficult, where there will be very little, if any, time for you to visit, find your way around, meet new teachers and just generally figure stuff out.

In this booklet there are a few tasks which will help you to understand how some of the more basic things work: getting lunch, how the school day works, what is expected of you, what subjects will be on your timetable etc.

The Basics

The biggest changes for you will be how far you must travel to get there and home each day, and that instead of being with one teacher all day, you will be moving from class to class throughout the day. And this will be exhausting!!

The other thing to remember is that instead of having only one teacher, you will have lots, and the most important thing you will need to know is who to see if you have a problem. At Gleniffer High School, pupils are divided into four 'houses' - groups of pupils with a common identity - Brodie, Glen, Moredun and Thornly. Each house has its own Depute Head Teacher, Principal Teacher of Pastoral Support and Teacher of Pupil Support. Nearer the time of your move, you will be told what class/ house you will be in, and who your main contact teachers will be.

Brodie House	Glen House	Moredun House	Thornly House
Mrs Martin DHT	Mr Gould DHT	Mrs Pless DHT	Mr Gray DHT
Mrs Collins PT Pastoral	Miss Bowie PT Pastoral	Miss Cameron PT Pastoral	Mrs Harris PT Pastoral
Miss Doherty PS Teacher	Mrs Kenny & Mr Slicer PS Teacher	Mrs Foley PS Teacher	Mrs Allan PS Teacher

Peek at a Week

Take a look at the S1 timetable on the next page. List the different subjects that the pupil goes to for the whole week. When they go to a subject more than once, use tally marks to show how many times per week they have that subject.

What kind of work do you think you will have to do in that subject?

Complete the table below.

[illegible]

The School Day

This is what an S1 timetable looks like

	1	2	3	4	5	6	7
Monday	French CfE Miss McCullagh G040	Science CfE Mr Ingledew F061	Religious Studies CfE Mrs Stewart G037	Home Economics CfE Mrs Crawford F030	English CfE Mrs Keay G004	Mathematics CfE Mr Wilson F007	Music CfE Mr Logan G056
Tuesday	Information Technology CfE Miss Dowd S022	Social Subjects CfE Mrs Graham F036	Art & Design CfE Mrs Frew S002	French CfE Mrs Bryan G038	Mathematics CfE Mr Wilson F007	English CfE Mrs Keay G004	Science CfE Miss Drysdale F061
	1	2	3	4	5	6	7
Wednesday	Information Technology CfE Miss Dowd S022	Music CfE Mrs Cowie G054	CfE Physical Activity and Sport CfE Miss Robb GamesHal	CfE Physical Activity and Sport CfE Miss Robb GamesHal	Art & Design CfE Mrs McNeil S005	Home Economics CfE Mrs Steedman F030	
	1	2	3	4	5	6	7
Thursday	Mathematics CfE Mr Wilson F007	Wider Achievement Award CfE Mrs Meechan G038	CfE Physical Activity and Sport CfE Mr Giles GamesHal	Personal & Social Education School Mrs Harris G028	Technological Studies CfE Miss Fusilli G067	Social Subjects CfE Mrs Graham F036	English CfE Ms Flett G005
	1	2	3	4	5	6	7
Friday	Mathematics CfE Mr Wilson F007	Social Subjects CfE Miss Bowie F037	Science CfE Mr Ingledew F061	English CfE Ms Flett G005	Technological Studies CfE Miss Fusilli G067	French CfE Miss McCullagh G040	

Monday, Tuesday and Thursday

Period	Times
1	8.50-9.40
2	9.40-10.30
Interval	10.30-10.45
3	10.45-11.35
4	11.35-12.25
5	12.25-1.15
Lunch	1.15-2.00
6	2.00-2.50
7	2.50-3.40

Wednesday and Friday

Period	Times
1	8.50-9.40
2	9.40-10.30
Break	10.30-10.45
3	10.45-11.35
4	11.35-12.25
Lunch	12.25-1.10
5	1.10-2.00
6	2.00-2.50

****Things to note:** Geography is on this timetable, but History and Modern Studies will all be available. You will spend a block of time in each one (History, Geography & Modern Studies) in your first year.

All together, these subjects are known as Humanities.

Working It Out

Use the timetable and school day information to answer the following questions.

1. If it takes you 25 minutes to walk to school each morning, what is the latest time you can leave to get to school on time?
2. If your pupil support teacher wants to see you at 10.55 on Tuesday, what period will you meet with her? Which subject will you miss?
3. You have a dentist appointment on Wednesday at 3pm, but your mum will pick you up 30 minutes before that. What subject(s) will you be missing?
4. You are absent on a Wednesday - when is the next day you will be able to catch up with work missed in a) English? b) Maths?
5. What day(s) will you need to bring your PE kit?
6. You will need a box to take home anything you make in Home Economics - what day should you bring it?
7. Why do you think you might need two periods in Home Economics?
8. The pupil council meeting is at 2pm on Wednesday - when do you think would be the best time to pass information to the class rep?
9. How long is lunch time?
10. If it takes 25 minutes for you to walk home, what time should you arrive home on Thursday?

Finding Your Way Around

Have a look at the map opposite. Pay careful attention to which floor particular subjects are found on. On which floor will you find:

1. Modern Languages
2. Art
3. Science
4. History (tricky - look back in your workbook)
5. Computing
6. The school office
7. Maths
8. The dining and social area

Now look at where the stairs are located.

How would you get from

9. Maths to English?
10. English to Science?
11. The school office to Spanish (THINK about it!)
12. Computing to the social area for lunch?
13. Now choose one day from the timetable shown and use a coloured pen to plot how you would move around the school.

Point to Note:
Classrooms are numbered with G (ground floor), F (first floor) and S (second floor) and a number to help you find your way around. These are the numbers on the timetable.

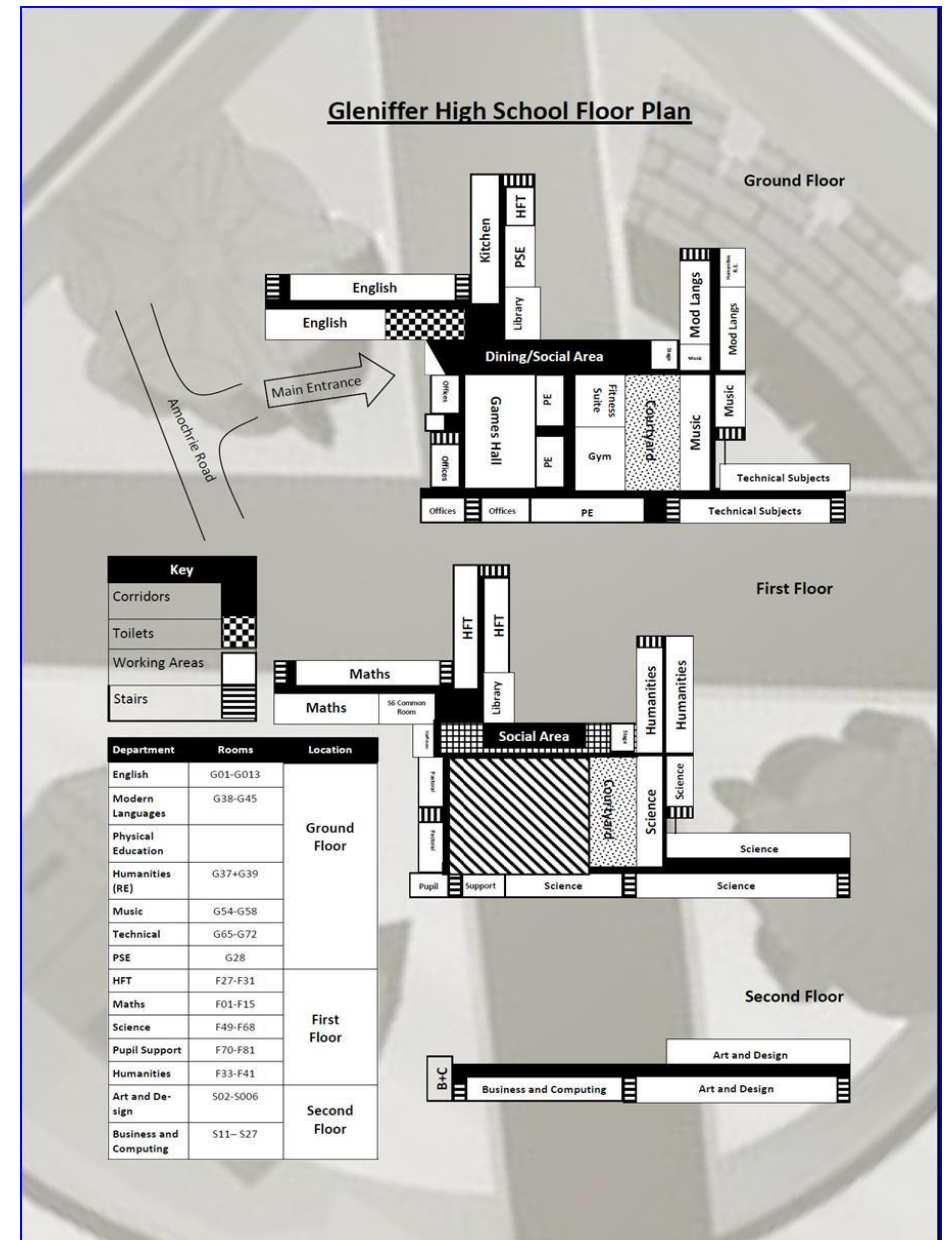

Lunchtimes

1. What do you normally do for lunch at primary school? Where do you go to eat you packed lunch/ school dinner? What is your favourite school dinner?
2. What do you think you will do for lunch when you get to Gleniffer High?
3. Look at the map on the previous page and decide: where do you think would be a sensible place to eat lunch on a a) sunny day? b) wet day?
4. Look at the menu on the next page. The menu covers one week of lunches at secondary school and it runs on a three-week rotation.

What day would you choose a meal deal from the main lunch menu?
What would you choose?

6. Can you plan out a healthy menu for the week?

Mon

Tue

Wed

Thur

Fri

School Meals

There are three weekly menus for secondary school food options. The cost is £2.70 for a main meal and other items on the food menu are individually priced.

Mid-morning break menu

Meal	Monday	Tuesday	Wednesday	Thursday	Friday
Mid-morning break	Roll (Chicken Lorne, Chicken Sausage, Potato Scone, Vegan Lorne), Toasts or Toasted Bagel	Roll (Chicken Lorne, Chicken Sausage, Potato Scone, Vegan Lorne), Toasts or Toasted Bagel	Roll (Chicken Lorne, Chicken Sausage, Potato Scone, Vegan Lorne), Toasts or Toasted Bagel	Roll (Chicken Lorne, Chicken Sausage, Potato Scone, Vegan Lorne), Toasts or Toasted Bagel	Roll (Chicken Lorne, Chicken Sausage, Potato Scone, Vegan Lorne), Toasts or Toasted Bagel

Main lunch menu

Meal	Monday	Tuesday	Wednesday	Thursday	Friday
Soup Starter	Vegetable Soup (Ve)	Tangy Tomato Soup (Ve)	Vegetable Soup (Ve)	Leek and Potato Soup (Ve)	Vegetable Soup (Ve)
Choice 1	Bangers 'N' Mash	Chicken Nuggets with Potato Wedges	Margherita Pizza (V)	Sloppy Joe's Tacos	Fish Fingers with Oven Chips
Choice 2	Creamy Pesto Bow-Tie Pasta with Garlic Bread (V)	Crispy Halloumi Burger with Potato Wedges (V)	Oriental Chow Mein (Ve)	Selection of Jacket Potato Choose from: Cheese (V), or Beans (Ve)	Steak Pie with Oven Chips
Side Vegetable	Broccoli (Ve) Carrot (Ve)	Rainbow Salad (Ve) Creamy Coleslaw (V)	Broccoli (Ve) Mexican-Style Corn Salad (Ve)	Rainbow Salad (Ve) Creamy Coleslaw (V)	Peas (Ve) Sweetcorn (Ve)
Dessert	Fluffy Waffle (V)	Cookie (V)	Oaty Flapjack (V)	Fruit Salad (Ve)	Peach Melba Sponge (V)

Grab and Go options

Meal	Monday	Tuesday	Wednesday	Thursday	Friday
Grab and Go everyday option	<p>Panini (hot), Baguette, Wrap, Sandwich, Salad Bowl, or Pasta Bowl of the Day.</p> <p>Choose from: Cheese (V), Cheese and Tomato (V), Chicken Tikka, BBQ Chicken, Tuna Mayo or Savoury Falafel (Ve)</p>	<p>Panini (hot), Baguette, Wrap, Sandwich, Salad Bowl, or Pasta Bowl of the Day.</p> <p>Choose from: Cheese (V), Cheese and Tomato (V), Chicken Tikka, BBQ Chicken, Tuna Mayo or Savoury Falafel (Ve)</p>	<p>Panini (hot), Baguette, Wrap, Sandwich, Salad Bowl, or Pasta Bowl of the Day.</p> <p>Choose from: Cheese (V), Cheese and Tomato (V), Chicken Tikka, BBQ Chicken, Tuna Mayo or Savoury Falafel (Ve)</p>	<p>Panini (hot), Baguette, Wrap, Sandwich, Salad Bowl, or Pasta Bowl of the Day.</p> <p>Choose from: Cheese (V), Cheese and Tomato (V), Chicken Tikka, BBQ Chicken, Tuna Mayo or Savoury Falafel (Ve)</p>	<p>Panini (hot), Baguette, Wrap, Sandwich, Salad Bowl, or Pasta Bowl of the Day.</p> <p>Choose from: Cheese (V), Cheese and Tomato (V), Chicken Tikka, BBQ Chicken, Tuna Mayo or Savoury Falafel (Ve)</p>
Grab and Go hot snack of the day option 1	<p>Pizza Subs</p> <p>Choose from: Pepperoni or Margherita (V)</p>	<p>Pizzini</p> <p>Choose from: Cheese Tomato (V) or Spicy Chicken</p>	<p>Burger</p> <p>Choose from: Crispy Chicken or Spicy Beans (V)</p>	<p>Loaded Fries</p> <p>Choose from: Salt and Chilli Chicken or Salt and Chilli Veg (V)</p>	<p>Pizzini</p> <p>Choose from: Cheese Tomato (V) or Spicy Chicken</p>
Grab and Go hot snack of the day option 2	<p>Toastie</p> <p>Choose from: Cheese and Tomato (V), Cheese and Onion (V), or Cheesy Veggie Haggis (V)</p>	<p>Chicken Rollover Hot Dog</p>	<p>Toastie</p> <p>Choose from: Cheese and Tomato (V), Cheese and Onion (V), or Cheesy Veggie Haggis (V)</p>	<p>Chicken Rollover Hot Dog</p>	<p>Toastie</p> <p>Choose from: Cheese and Tomato (V), Cheese and Onion (V), or Cheesy Veggie Haggis (V)</p>

Our systems are cashless so you are given your own number to use when paying in the canteen. Money is put onto your account using Parent Pay. S1 pupils are NOT PERMITTED to leave school grounds at any time.

Homework

Myth	Reality
There will be loads of homework for every subject. I'll never be able to manage it all.	Teachers will never ask you to do a lot at home, and you will always be given a reasonable deadline.
The homework will be too hard - I'll never be able to do it all!	Teachers will never ask you to do something you haven't been taught.
Once I have it at home, there's no-one to help me.	If someone at home can't help you, you can ask a classmate. You will be able to ask your teacher the next day, or send a message via "Show My Homework" (see below).

Gleniffer High School manages homework through an online programme called **"Show My Homework"**.

At the beginning of the year you will be issued with a username and password (so will your parents/ carers) and you will be shown how to use it. All your homework will be issued here, with all the resources that you need, and you can access it from school and home, and via an app on your phone whenever you need to. You can also use this programme to contact your teacher from home if you get stuck (just remember that sometimes teachers stop working and have time with their families, so they may not reply right away!).

Write down below what homework you are expected to complete each week from primary school. (Think about reading, spelling, maths, sentences, research topics, work towards big projects...)

Have a look at the organisation task on the next page. This is an illustration of a VERY busy day... BUT DON'T PANIC!!!

Planning How to Use Your Time

Imagine you are given the following homework on a Monday. Use the grid below to help you to plan and organise your time.

Geography - one page of the homework booklet which includes answering three questions based on work done in class, drawing a diagram that you went over in class and researching three facts online. To be handed in next MONDAY.

English - Reading three chapters of your class novel for FRIDAY.

Drama - Come in next MONDAY prepared to storyboard a three minute mime, as you discussed in your group today.

Maths - one page of the homework booklet due to be submitted each day this week, to prepare for a test. There are five questions on each page and each page should take no longer than 20 minutes.

Spanish - Revise days of the week and months of the year for a quick vocabulary quiz at the beginning of the period on WEDNESDAY.

IT - There is a big project using all of the skills you have learned in this unit due to be submitted in 4 weeks. You are expected to complete at least one task per week.

Day	After school-tea time	6 - 7.15pm	7.45 - 9pm
Mon			
Tue			Karate Training
Wed	Games Club in library		
Thur			Football / Netball Training
Fri			

Day	Late AM	Early Afternoon	Late Afternoon	Evening
Sat	Football Match		Watching Football	Favourite TV Programmes
Sun			Going to Dancing Display	

School Values

Gleniffer High School has five school values.

Acceptance

Ambition

Nurture

Respect

Trust



Look up each of these words and write down what it means. Give an example of how you could demonstrate this at school and in your own home.

Acceptance:

Ambition:

Nurture:

Respect:

Trust:

Expectations

Like your primary school, Gleniffer High School has high expectations of all the people who attend the school and work in the school.

Here is what you should expect:

Expectations of staff:

- Show pupils kindness and respect
- Listen to pupils, value their contributions, and respect their views
- Create a positive learning environment where pupils feel welcome
- Meet and greet learners at the start of each lesson at the classroom door
- Create well prepared lessons, making use of available resources, and meeting the needs of all pupils
- Resources including pens/pencils will be available for learners
- Have high aspirations and acknowledge effort and achievement whilst providing support and guidance
- Recognise every child's strengths and believe that every child has the ability to learn (especially children with ASN).
- Show interest and enthusiasm in response to pupils' work and celebrate progress
- Discuss "Expectations" and consequences so that all children understand clearly what is expected of them
- Always recognise and celebrate positive behaviour and attitudes around the school
- Give first attention to those doing the right thing

What might you see from staff which would demonstrate these expectations?

Expectations of learners:

- We wear a high standard of uniform. Our hoods, hats and gloves are removed inside the building.
- We move safely around the building.
- We enter classes ready to learn.
- Our phones and earphones are in bags.
- We listen carefully to teacher instructions.
- We only eat food and drink in the social area.
- We use toilets before school, at interval and lunchtime.
- We treat other pupils, staff and school property respectfully.
- We follow staff instructions.

What might you do to make sure you are meeting these expectations?